

**5 HOLE, PAR 3  
GOLF COURSE**

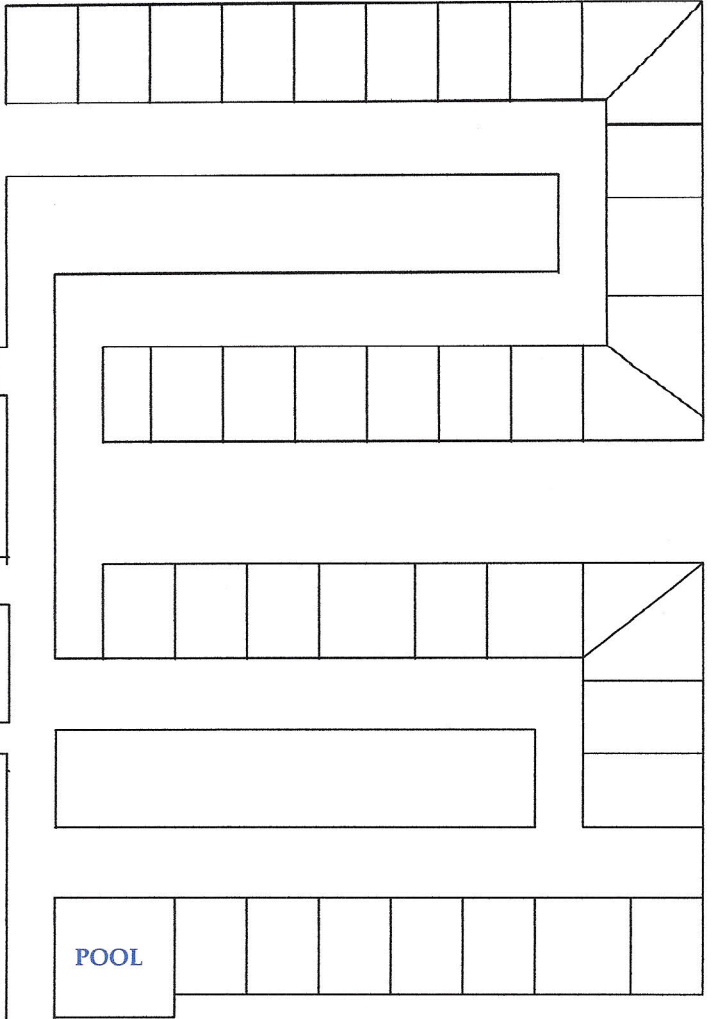

**AVAILABLE SITES FOR THE  
2011 SEASON  
SECTIONS  
200 \* 300 \* 400 \* 500**

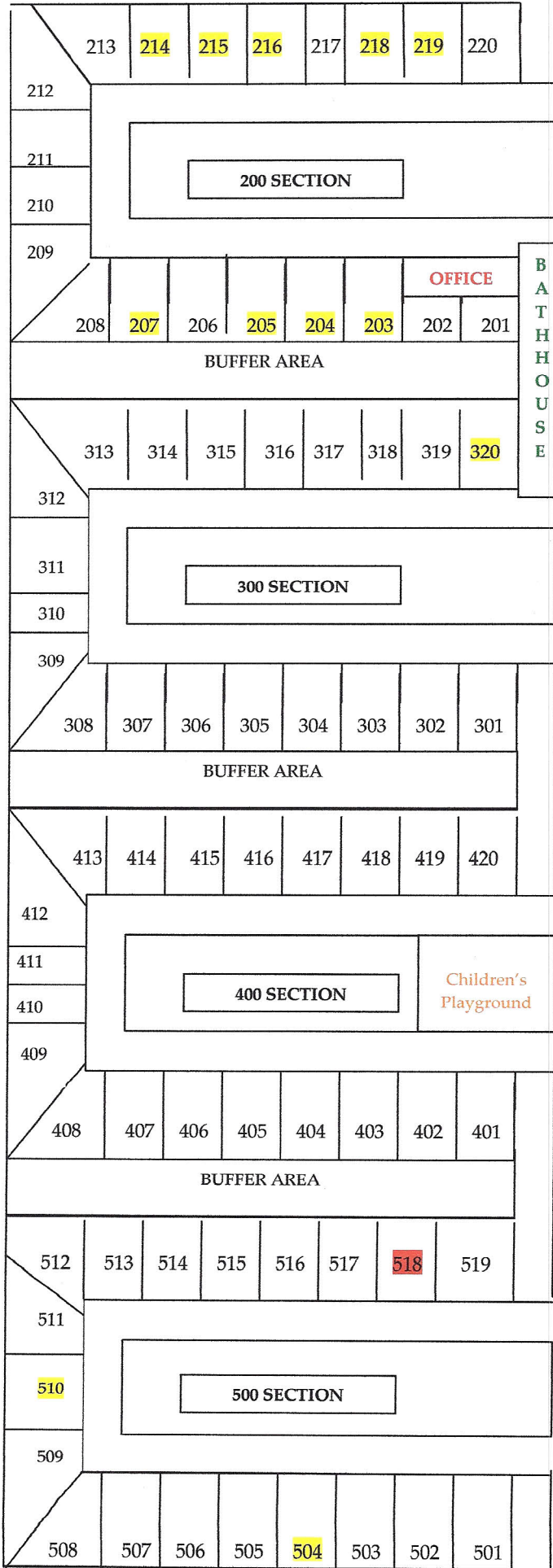

165 FREMONT AVENUE \* WOODBINE, NEW JERSEY 08270  
PH (609) 861-1001 \* FAX (609) 427-6248  
WEBSITE [www.clcrest.com](http://www.clcrest.com)

**\$1,000.00 DEPOSIT WILL RESERVE  
THE SITE OF YOUR CHOICE**

- Available Sites
- Park Models for Sale

MAP IS NOT TO SCALE

ENTRANCE GATE

FREMONT AVENUE

FREMONT AVENUE